



ANNUAL MEETING

Research & Industry Update

JANUARY 14 & 15, 2016

*Salishan Lodge & Golf Resort
Gleneden Beach, Oregon*

SPONSORED BY OREGON ESSENTIAL OIL GROWERS LEAGUE

THURSDAY, JANUARY 14, 2016

TERRACE ROOM

8:15 a.m. Meeting Registration Opens

LONGHOUSE ROOM A

8:15 a.m. Exhibitor Displays

Coffee and Tea

Courtesy of Labbeemint, Inc.

Muffins and Scones (while they last)

Courtesy of Northwest Farm Credit Services

LONGHOUSE ROOMS B AND C

8:55 a.m. Welcome, *Tim Butler, OEOGL Chairman*

9:00 a.m. Integrated Pest Management
of Verticillium Wilt

Jeremiah Dung

Oregon State University

Madras, Oregon

9:30 a.m. Understanding the Direction of
Biotechnology in Mint

Steve Salisbury,

Research and Regulatory Coordinator

Mint Industry Research Council

Sublimity, Oregon

9:45 a.m. Gene Mapping and Biotechnology in Mint

**Part One: Biotechnology and Advances
in Transgenic Lines**

Mark Lange

Washington State University

Pullman, Washington

10:15 a.m. Coffee and Exhibits

Coffee and Tea

Courtesy of RCB International, Ltd.

10:30 a.m. Gene Mapping and Biotechnology in Mint

**Part Two: Development of Genome
Resources in Mint**

Kelly Vining

Oregon State University

Corvallis, Oregon

11:00 a.m. Gaining Perspectives on Challenging
Mint Topics – Panel Discussion

Neil Christensen and Steve Salisbury -

Moderators

CEDAR TREE

12:00 p.m. Lunch

LONGHOUSE ROOMS B AND C

1:15 p.m. Evaluating Crop Injury from
Herbicide Applications When Rotating
to Kentucky Bluegrass or Wheat

Marvin Butler

Oregon State University

Madras, Oregon

1:45 p.m. 2016 Fertilizer Forecast –
What Growers Can Expect

Josh Ehrhart

Wilbur-Ellis Company, NW Operations

Wilsonville, Oregon

2:15 p.m. The Food Safety Modernization Act –
Impacts Farm Distillers and the Mint Industry
Need to Know

Stephanie Page

Oregon Department of Agriculture

Salem, Oregon

2:45 p.m. Business Meeting Election of Directors

Tim Butler

OEOGL Chairman, Presiding

3:00 p.m. Mint Industry Research Council –
Chairman's Report

A.J. Todd

A.M. Todd Company

Kalamazoo, Michigan

3:15 p.m. Chemical Registrations, National Research
and the 2016 Green Survey

Steve Salisbury,

Research and Regulatory Coordinator

Mint Industry Research Council

Sublimity, Oregon

CEDAR HOUSE

4:15 p.m. Industry Reception
Hors d'oeuvres and No-Host Bar

Sponsored in part by IP Callison & Sons

FRIDAY, JANUARY 15, 2016

TERRACE ROOM

8:00 a.m. Meeting Registration Opens

LONGHOUSE ROOM A

8:00 a.m. Exhibit Displays

Coffee and Tea

Courtesy of A.M. Todd Company

Muffins and Scones (while they last)

Courtesy of Cole Industrial

LONGHOUSE ROOMS B AND C

8:30 a.m. The Mint Industry Electronic Newsletter –
Advanced Management Tools*Clare Sullivan**Oregon State University**Corvallis, Oregon*9:00 a.m. The Effects of Applying Varying Amounts
of Mint Slugs to Established Mint*Bryan Quebbeman**Quebbeman Crop Management**LaGrande, Oregon*9:30 a.m. Efficacy and Crop Safety of Zidua in
NE Oregon Mint Production*Bryan Quebbeman**Quebbeman Crop Management**LaGrande, Oregon*10:00 a.m. Effectively Managing Weeds in
Oregon Mint: Willamette Valley and
Statewide Research Program Updates*Andy Hulting**Oregon State University**Corvallis, Oregon*10:45 a.m. Life After Paulette and What to Expect
for Oregon's 2016 Legislative Session*Katy Fast**Oregonians for Food and Shelter**Salem, Oregon*11:15 a.m. The North American Mint Industry –
Buyer's Viewpoint*Mark Nelson**A.M. Todd Company**Caldwell, Idaho*

Adjourn

*A special thanks to the
coffee break sponsors,
reception sponsor and advertisers.*

PREREGISTRATION FORM • Preregistration Deadline is December 31, 2015

Name of Participant(s) _____

(one name for each \$28 registration fee paid) _____

Address _____

City _____ State _____ Zip _____ Phone _____

Where would you like the 2017 annual meeting held? (check one) ☐ Coast ☐ Portland ☐ Central Oregon ☐ Southern Oregon

NUMBER	ITEM	PREREGISTRATION	AT THE DOOR	COST
_____	Annual Meeting Registration (Includes one ticket to Industry Reception)	\$28.00 ea.	\$33.00 ea.	\$ _____
_____	Thursday Luncheon	\$14.50 ea.	\$16.00 ea.	\$ _____
_____	* Thursday Industry Reception	\$10.00 ea.*	\$10.00 ea.*	\$ _____*
_____	League Membership (One directory listing for each \$40 membership fee paid)	\$40.00	\$40.00	\$ _____
			TOTAL ENCLOSED	\$ _____

* One ticket to Industry Reception included with each paid registration

Are you interested in running for the OEOGL Board? Name _____ Phone _____

SALISHAN LODGE & GOLF RESORT INFORMATION

HOTEL RESERVATIONS

Make reservations directly with:
Salishan Lodge & Golf Resort
Post Office Box 118
Gleneden Beach, Oregon 97388
1-800-452-2300



ROOM RATES PER NIGHT:

Deluxe Non-view Room\$103 + 10% room tax
Deluxe Guest Room.....\$123 + 10% room tax
Premier Guest Room\$143 + 10% room tax

Be sure to make hotel reservations by phone
by their **December 23** deadline.

They fill up fast, so don't delay!

*(When registering by phone, tell the operator you
are attending the mint growers convention to get
the very special room rates.)*

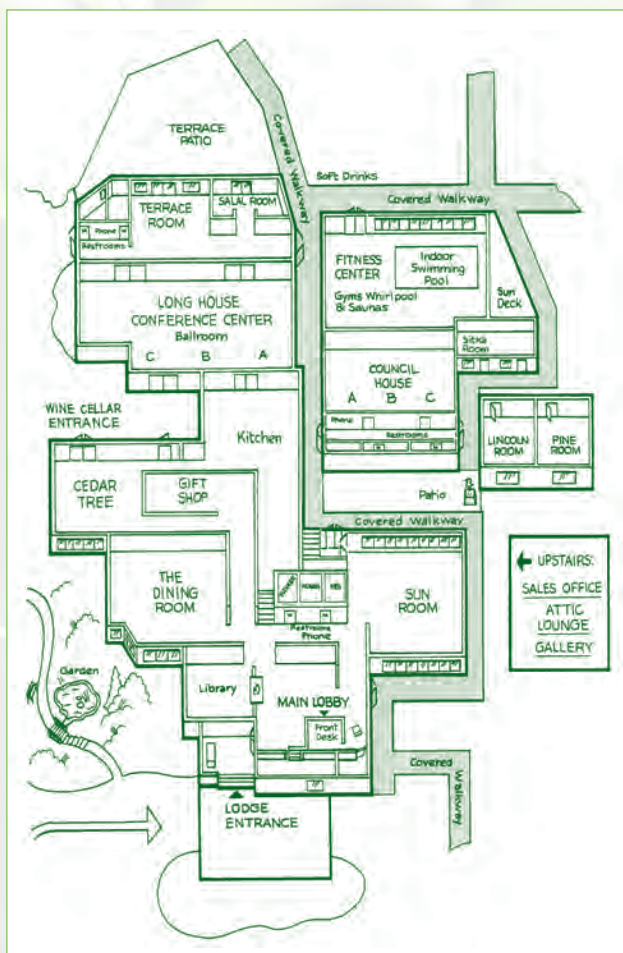

PREREGISTRATION DEADLINE IS DECEMBER 31, 2015

Preregistration is an easy way to register for the Annual Meeting. It facilitates meal projections, minimizes time required at the registration desk and saves you money over registering at the door. Preregistration packets may be picked up at the League's registration desk the day of the meeting.

Mail preregistration form with check payable to:

O.E.O.G.L. - Post Office Box 3366
Salem, Oregon 97302 • (503) 364-2944



OREGON ESSENTIAL OIL GROWERS LEAGUE

P. O. Box 3366, Salem, Oregon 97302
(503) 364-2944 • FAX (503) 581-6819

Visit **oregonmint.org** for more information.