

66<sup>th</sup> ANNUAL



OREGONmint  
GROWERS

ANNUAL MEETING PROGRAM  
*Research & Industry Update*

**JANUARY 8 & 9, 2015**

Sallishan Lodge & Golf Resort  
Glenden Beach, Oregon

SPONSORED BY OREGON ESSENTIAL OIL GROWERS LEAGUE

THURSDAY, JANUARY 8, 2015

**TERRACE ROOM**

8:00 a.m. Meeting Registration

**LONGHOUSE ROOM A**

8:00 a.m. Exhibitor Displays

*Coffee and Tea*

*Courtesy of A.M. Todd Company*

*Muffins and Scones (while they last)*

*Courtesy of Cole Industrial*

**LONGHOUSE ROOMS B AND C**

8:55 a.m. Welcome, *Tim Butler, OEOGL Chairman*

9:00 a.m. **MIRC – Moving Forward with New Personnel and Priorities**

*A.J. Todd, Chairman*

*Mint Industry Research Council*

*Kalamazoo, Michigan*

9:15 a.m. **MIRC – Chemical Registrations and Research: Building New Programs for the National Mint Industry**

*Steve Salisbury,*

*Research and Regulatory Coordinator*

*Mint Industry Research Council*

*Sublimity, Oregon*

9:45 a.m. **Mint Production – Fresh Perspectives on Equipment and Scale**

*Dale Thacker*

*Bow Island, Alberta, Canada*

10:30 a.m. **Coffee and Exhibits**

*Coffee and Tea - Courtesy of Labbeemint, Inc.*

10:45 a.m. **Food Safety Modernization Act – A Review of the Latest Rules and Grower/Handler Impacts**

*Stephanie Page*

*Oregon Department of Agriculture*

*Salem, Oregon*

11:15 a.m. **Looking to the Future with OSU's College of Ag Science**

*Dan Arp, Dean*

*Oregon State University*

*Corvallis, Oregon*

**CEDAR TREE**

11:45 a.m. Lunch

**LONGHOUSE ROOMS B AND C**

1:15 p.m. **Biotechnology Advances in Mint**

**Part One: Advances in Transgenic Lines**

*Mark Lange*

*Washington State University*

*Pullman, Washington*

**Part Two: Development of Genome Resources**

*Kelly Vining*

*Oregon State University*

*Corvallis, Oregon*

2:15 p.m. **Business Meeting and Election of Directors**

*Tim Butler*

*OEOGL Chairman, Presiding*

2:30 p.m. **New Approaches to Reducing Wilt in Mint**

*Jeremiah Dung*

*Oregon State University*

*Madras, Oregon*

3:00 p.m. **Encouraging OSU's Bright Young Minds – Non-Traditional Approaches to Distillation**

*David Hackleman*

*Oregon State University*

3:15 p.m. **Research Round-Up – Where Have We Been and Discussion of Priorities. Researcher Panel Presentation.**

4:15 p.m. Exhibit Area Open

**CEDAR HOUSE**

4:15 p.m. **Industry Reception**

**Hors d'oeuvres and No-Host Bar**

*Sponsored in part by IP Callison & Sons*

FRIDAY, JANUARY 9, 2015

**TERRACE ROOM**

8:00 a.m. Meeting Registration

**LONGHOUSE ROOM A**

8:00 a.m. Exhibit Displays

Coffee and Tea –  
 Courtesy of RCB International, Ltd.  
 Muffins and Scones (while they last)  
 Courtesy of Northwest Farm Credit Services

**LONGHOUSE ROOM B AND C**

8:30 a.m. Research Updates from Eastern Oregon

**The Effects of Applying Mint Slugs  
 to Established Mint and Issues of Interest  
 on the East Side**

Bryan Quebbeman  
 Quebbeman Crop Management  
 LaGrande, Oregon

9:00 a.m. The New Mint Pest Alert Newsletter

Marvin Butler  
 Oregon State University, Madras, Oregon

9:30 a.m. Doing Your Part to Protect Pollinators

Helmuth Rogg  
 Oregon Department of Agriculture  
 Salem, Oregon

10:00 a.m. Effectively Managing Weeds in Oregon Mint

**Part One: Willamette Valley and  
 Statewide Research Program Updates**

Andy Hulting  
 Oregon State University  
 Corvallis, Oregon

**Part Two: Field Bindweed Biocontrol Update**

Jessica Green  
 Oregon State University  
 Corvallis, Oregon

10:45 a.m. Calibrating Your Expectations for the  
 2015 Legislative Session

Paulette Pyle  
 Oregonians for Food and Shelter  
 Salem, Oregon

11:15 a.m. The North American Mint Industry –  
 Buyer's Viewpoint

Les Toews  
 IP Callison & Sons  
 Lacey, Washington

Adjourn

*A special thanks to the  
 coffee break sponsors,  
 reception sponsor and advertisers.*



**PREREGISTRATION FORM • Preregistration Deadline is December 31, 2014**

Name of Participant(s) \_\_\_\_\_

(one name for each \$28 registration fee paid) \_\_\_\_\_

Address \_\_\_\_\_

City \_\_\_\_\_ State \_\_\_\_\_ Zip \_\_\_\_\_ Phone \_\_\_\_\_

Where would you like the 2016 annual meeting held? (check one)  Coast  Portland  Central Oregon  Southern Oregon

NUMBER	ITEM	PREREGISTRATION	AT THE DOOR	COST
_____	Annual Meeting Registration (Includes one ticket to Industry Reception)	\$28.00 ea.	\$33.00 ea.	\$ _____
_____	Thursday Luncheon	\$14.50 ea.	\$16.00 ea.	\$ _____
_____	* Thursday Industry Reception	\$10.00 ea.*	\$10.00 ea.*	\$ _____*
_____	League Membership (One directory listing for each \$40 membership fee paid)	\$40.00	\$40.00	\$ _____
			<b>TOTAL ENCLOSED</b>	\$ _____

\* One ticket to Industry Reception included with each paid registration

Are you interested in running for the OEOGL Board? Name \_\_\_\_\_ Phone \_\_\_\_\_

# SALISHAN LODGE & GOLF RESORT INFORMATION

## HOTEL RESERVATIONS

Make reservations directly with:  
**Salishan Lodge & Golf Resort**  
Post Office Box 118  
Gleneden Beach, Oregon 97388  
1-800-452-2300



## ROOM RATES PER NIGHT:

Standard Guest Room.....\$103 + 10% room tax  
Deluxe Guest Room.....\$123 + 10% room tax  
Premier Guest Room .....\$143 + 10% room tax

Be sure to make hotel reservations by phone by their **December 18** deadline.

***They fill up fast, so don't delay!***

*(When registering by phone, tell the operator you are attending the mint growers convention to get the very special room rates.)*

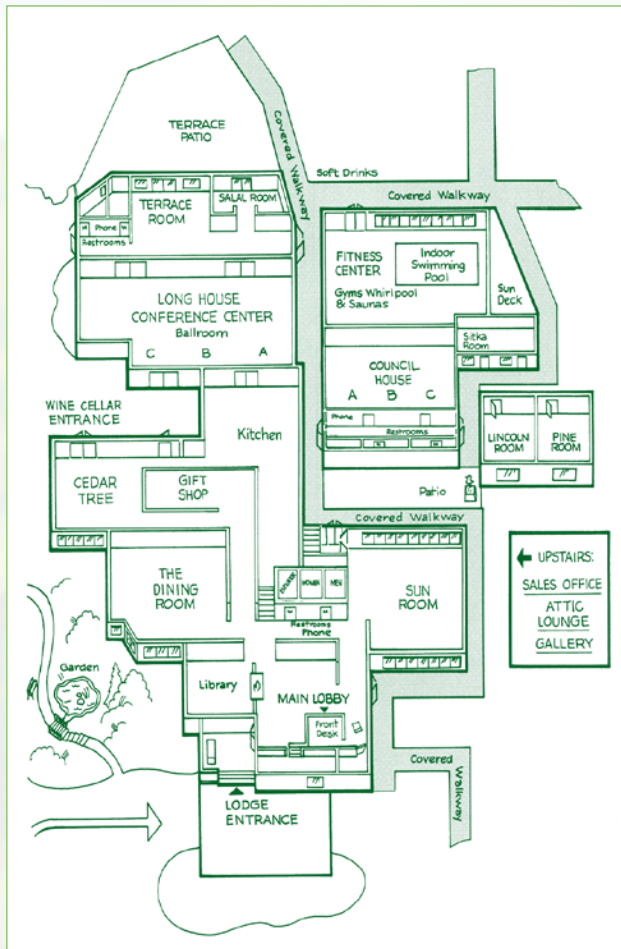

## PREREGISTRATION DEADLINE IS DECEMBER 31, 2014

Preregistration is an easy way to register for the Annual Meeting. It facilitates meal projections, minimizes time required at the registration desk and saves you money over registering at the door. Preregistration packets may be picked up at the League's registration desk the day of the meeting.

### Mail preregistration form with check payable to:

O.E.O.G.L. - Post Office Box 3366  
Salem, Oregon 97302 • (503) 364-2944



## OREGON ESSENTIAL OIL GROWERS LEAGUE

P. O. Box 3366, Salem, Oregon 97302  
(503) 364-2944 • FAX (503) 581-6819

Visit [oregonmint.org](http://oregonmint.org) for more information.