

68th Annual

OREGON



mint

G R O W E R S

ANNUAL MEETING

JANUARY 12 & 13, 2017

*Salishan Lodge & Golf Resort
Gleneden Beach, Oregon*

SPONSORED BY OREGON ESSENTIAL OIL GROWERS LEAGUE

THURSDAY, JANUARY 12, 2017

TERRACE ROOM

8:00 a.m. Meeting Registration Opens

LONGHOUSE ROOM A

8:00 a.m. Exhibitor Displays

Coffee and Tea –

Courtesy of RCB International, Ltd.

Muffins and Scones (while they last)

Courtesy of Cole Industrial

LONGHOUSE ROOMS B AND C

8:55 a.m. Welcome

Tim Butler, OEOGL Chairman

**9:00 a.m. Advances in Understanding
and IPM of *Verticillium* Wilt**

Jeremiah Dung,

Oregon State University, Madras

**9:30 a.m. The Challenge of Forecasting Weather
in the PNW - Partly to Mostly and The
Little Children - La Niña y El Niño**

Rufus La Lone,

The Weather Café, Silverton

10:15 a.m. Coffee and Exhibits

Coffee and Tea -

Courtesy of A.M. Todd Co.

10:45 a.m. Advancements in the War on Weeds

Andy Hulting,

Oregon State University, Corvallis

11:15 a.m. Getting the Most Out of the Mint eNewsletters

Clare Sullivan

Oregon State University, Tangent

**11:30 a.m. Understanding Fungicide Impacts
on Mint Yields**

Bryon Quebbeman,

Quebbeman Crop Management, La Grande

CEDAR TREE

12:00 p.m. LUNCH

LONGHOUSE ROOMS B AND C

**1:15 p.m. Registration of Mint Stills and Preparing
for the Food Safety Modernization Act**

Stephanie Page,

Oregon Department of Agriculture, Salem

**1:45 p.m. Understanding New Potential Herbicides
on Mint**

Bryon Quebbeman,

Quebbeman Crop Management, La Grande

**2:15 p.m. Defending Oregon Natural Resource Industries
and What to Expect in the 2017
Legislative Session**

Katie Fast,

Oregonians for Food and Shelter, Salem

2:45 p.m. Business Meeting

Tim Butler, OEOGL Chairman, Presiding

3:00 p.m. Chemical Updates, National Research Review

Steve Salisbury,

Research and Regulatory Coordinator

Mint Industry Research Council

CEDAR HOUSE

4:15 p.m. Reception

Hors d'oeuvres and No-Host Bar

Sponsored in part by Callisons



Visit oregonmint.org for more information.

FRIDAY, JANUARY 13, 2017

TERRACE ROOM

8:00 a.m. Meeting Registration Opens

LONGHOUSE ROOM A

8:00 a.m. Exhibitor Displays

Coffee and Tea – *Courtesy of Labbeemint, Inc.*
 Muffins and Scones (while they last)
Courtesy of Northwest Farm Credit Services

LONGHOUSE ROOMS B AND C

8:30 a.m. Gene Mapping and Biotechnology in Mint

Part One: Integrated Genomics
and Plant Breeding, WSU

Mark Lang,
Washington State University, Pullman, Washington

Part Two: Integrated Genomics
and Plant Breeding, OSU

Kelly Vining,
Oregon State University, Corvallis

Part Three: Mapping the Genomics of Mint,
Verticillium Isolates

Kelly Vining,
Oregon State University, Corvallis

9:45 a.m. Recreational Marijuana and Hemp –
An Update on Oregon Ag's New Partners

Lindsay Eng,
Oregon Department of Agriculture, Portland

10:15 a.m. The Legal Side of Labor –
Examining the Risks and Implementing
Solutions for Ag Employers

David Biggs,
Employment Law, Litigation,
Saalfeld Griggs, PC, Salem

10:45 a.m. Biological Evaluations of Organophosphates
(Lorsban), Application Exclusion Zones
and Regulatory Updates

Rose Kachadoorian,
Oregon Department of Agriculture, Salem

11:15 a.m. The North American and Global Mint Industry –
Buyer's Viewpoint

C.J. St. Hilaire,
Labbeemint, Inc., Harrah, Washington

**A special thanks to the coffee break
sponsors, reception sponsor
and advertisers.**

PREREGISTRATION FORM • Preregistration Deadline is December 30, 2016

Name of Participant(s) _____

(one name for each \$28 registration fee paid) _____

Address _____

City _____ State _____ Zip _____ Phone _____

Where would you like the 2018 annual meeting held? (check one) ☐ Coast ☐ Portland ☐ Central Oregon ☐ Southern Oregon

NUMBER	ITEM	PREREGISTRATION	AT THE DOOR	COST
_____	Annual Meeting Registration (Includes one ticket to Industry Reception)	\$28.00 ea.	\$33.00 ea.	\$ _____
_____	Thursday Luncheon	\$14.50 ea.	\$16.00 ea.	\$ _____
_____	* Thursday Industry Reception	\$10.00 ea.*	\$10.00 ea.*	\$ _____*
_____	League Membership (One directory listing for each \$40 membership fee paid)	\$40.00	\$40.00	\$ _____
TOTAL ENCLOSED				\$ _____

* One ticket to Industry Reception included with each paid registration

Are you interested in running for the OEOGL Board? Name _____ Phone _____

SALISHAN LODGE & GOLF RESORT INFORMATION

HOTEL RESERVATIONS

Make reservations directly with:
Salishan Lodge & Golf Resort
Post Office Box 118
Gleneden Beach, Oregon 97388
1-800-452-2300



ROOM RATES PER NIGHT:

Deluxe Non-view Room\$106 + 10% room tax
Deluxe Guest Room.....\$126 + 10% room tax
Premier Guest Room\$146 + 10% room tax

Be sure to make hotel reservations by phone
by their **December 21** deadline.

They fill up fast, so don't delay!

*(When registering by phone, tell the operator you
are attending the mint growers convention to get
the very special room rates.)*

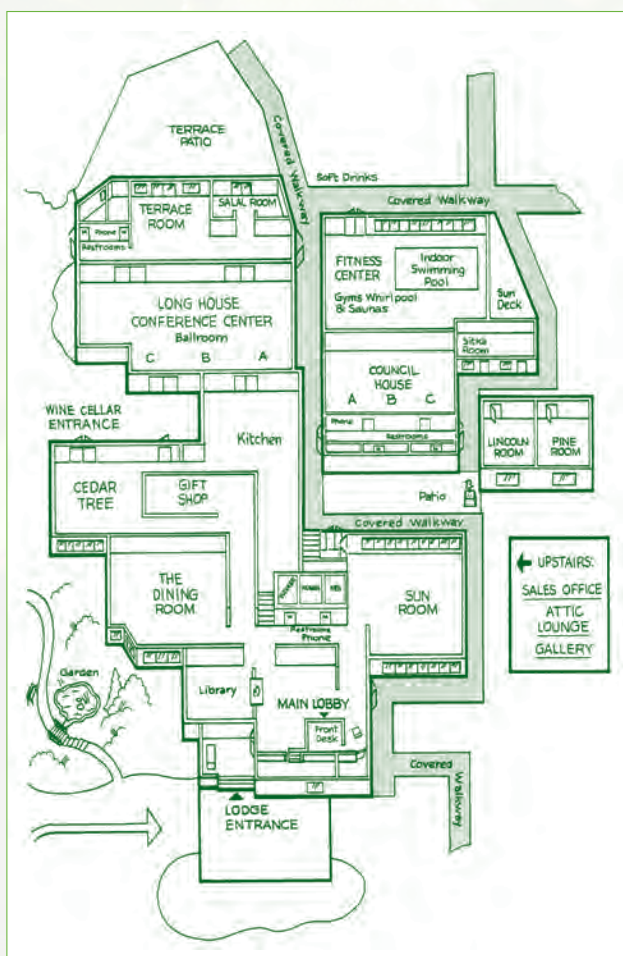

PREREGISTRATION DEADLINE IS DECEMBER 30, 2016

Preregistration is an easy way to register for the Annual Meeting. It facilitates meal projections, minimizes time required at the registration desk and saves you money over registering at the door. Preregistration packets may be picked up at the League's registration desk the day of the meeting.

Mail preregistration form with check payable to:

O.E.O.G.L. - Post Office Box 3366
Salem, Oregon 97302 • (503) 364-2944



OREGON ESSENTIAL OIL GROWERS LEAGUE

P. O. Box 3366, Salem, Oregon 97302
(503) 364-2944 • FAX (503) 581-6819

Visit oregonmint.org for more information.