

66th ANNUAL



OREGONmint
GROWERS

ANNUAL MEETING PROGRAM
Research & Industry Update

JANUARY 8 & 9, 2015

Sallishan Lodge & Golf Resort
Glenden Beach, Oregon

SPONSORED BY OREGON ESSENTIAL OIL GROWERS LEAGUE

THURSDAY, JANUARY 8, 2015

TERRACE ROOM

8:00 a.m. Meeting Registration

LONGHOUSE ROOM A

8:00 a.m. Exhibitor Displays

Coffee and Tea

Courtesy of A.M. Todd Company

Muffins and Scones (while they last)

Courtesy of Cole Industrial

LONGHOUSE ROOMS B AND C

8:55 a.m. Welcome, *Tim Butler, OEOGL Chairman*

9:00 a.m. **MIRC – Moving Forward with New Personnel and Priorities**

A.J. Todd, Chairman

Mint Industry Research Council

Kalamazoo, Michigan

9:15 a.m. **MIRC – Chemical Registrations and Research: Building New Programs for the National Mint Industry**

Steve Salisbury,

Research and Regulatory Coordinator

Mint Industry Research Council

Sublimity, Oregon

9:45 a.m. **Mint Production – Fresh Perspectives on Equipment and Scale**

Dale Thacker

Bow Island, Alberta, Canada

10:30 a.m. **Coffee and Exhibits**

Coffee and Tea - Courtesy of Labbeemint, Inc.

10:45 a.m. **Food Safety Modernization Act – A Review of the Latest Rules and Grower/Handler Impacts**

Stephanie Page

Oregon Department of Agriculture

Salem, Oregon

11:15 a.m. **Looking to the Future with OSU's College of Ag Science**

Dan Arp, Dean

Oregon State University

Corvallis, Oregon

CEDAR TREE

11:45 a.m. Lunch

LONGHOUSE ROOMS B AND C

1:15 p.m. **Biotechnology Advances in Mint**

Part One: Advances in Transgenic Lines

Mark Lange

Washington State University

Pullman, Washington

Part Two: Development of Genome Resources

Kelly Vining

Oregon State University

Corvallis, Oregon

2:15 p.m. **Business Meeting and Election of Directors**

Tim Butler

OEOGL Chairman, Presiding

2:30 p.m. **New Approaches to Reducing Wilt in Mint**

Jeremiah Dung

Oregon State University

Madras, Oregon

3:00 p.m. **Encouraging OSU's Bright Young Minds – Non-Traditional Approaches to Distillation**

David Hackleman

Oregon State University

3:15 p.m. **Research Round-Up – Where Have We Been and Discussion of Priorities. Researcher Panel Presentation.**

4:15 p.m. **Exhibit Area Open**

CEDAR HOUSE

4:15 p.m. **Industry Reception**

Hors d'oeuvres and No-Host Bar

Sponsored in part by IP Callison & Sons

FRIDAY, JANUARY 9, 2015

TERRACE ROOM

8:00 a.m. Meeting Registration

LONGHOUSE ROOM A

8:00 a.m. Exhibit Displays

Coffee and Tea –
 Courtesy of RCB International, Ltd.

 Muffins and Scones (while they last)
 Courtesy of Northwest Farm Credit Services

LONGHOUSE ROOM B AND C

8:30 a.m. Research Updates from Eastern Oregon

**The Effects of Applying Mint Slugs
 to Established Mint and Issues of Interest
 on the East Side**

Bryan Quebbeman
 Quebbeman Crop Management
 LaGrande, Oregon

9:00 a.m. The New Mint Pest Alert Newsletter

Marvin Butler
 Oregon State University, Madras, Oregon

9:30 a.m. Doing Your Part to Protect Pollinators

Helmuth Rogg
 Oregon Department of Agriculture
 Salem, Oregon

10:00 a.m. Effectively Managing Weeds in Oregon Mint

**Part One: Willamette Valley and
 Statewide Research Program Updates**

Andy Hulting
 Oregon State University
 Corvallis, Oregon

Part Two: Field Bindweed Biocontrol Update

Jessica Green
 Oregon State University
 Corvallis, Oregon

10:45 a.m. Calibrating Your Expectations for the
 2015 Legislative Session

Paulette Pyle
 Oregonians for Food and Shelter
 Salem, Oregon

11:15 a.m. The North American Mint Industry –
 Buyer's Viewpoint

Les Toews
 IP Callison & Sons
 Lacey, Washington

Adjourn

*A special thanks to the
 coffee break sponsors,
 reception sponsor and advertisers.*



PREREGISTRATION FORM • Preregistration Deadline is December 31, 2014

Name of Participant(s) _____

(one name for each \$28 registration fee paid) _____

Address _____

City _____ State _____ Zip _____ Phone _____

Where would you like the 2016 annual meeting held? (check one) Coast Portland Central Oregon Southern Oregon

NUMBER	ITEM	PREREGISTRATION	AT THE DOOR	COST
_____	Annual Meeting Registration (Includes one ticket to Industry Reception)	\$28.00 ea.	\$33.00 ea.	\$ _____
_____	Thursday Luncheon	\$14.50 ea.	\$16.00 ea.	\$ _____
_____	*Thursday Industry Reception	\$10.00 ea.*	\$10.00 ea.*	\$ _____*
_____	League Membership (One directory listing for each \$40 membership fee paid)	\$40.00	\$40.00	\$ _____
			TOTAL ENCLOSED	\$ _____

* One ticket to Industry Reception included with each paid registration

Are you interested in running for the OEOGL Board? Name _____ Phone _____

SALISHAN LODGE & GOLF RESORT INFORMATION

HOTEL RESERVATIONS

Make reservations directly with:
Salishan Lodge & Golf Resort
Post Office Box 118
Gleneden Beach, Oregon 97388
1-800-452-2300



ROOM RATES PER NIGHT:

Standard Guest Room.....\$103 + 10% room tax
Deluxe Guest Room.....\$123 + 10% room tax
Premier Guest Room\$143 + 10% room tax

Be sure to make hotel reservations by phone by their **December 18** deadline.

They fill up fast, so don't delay!

(When registering by phone, tell the operator you are attending the mint growers convention to get the very special room rates.)

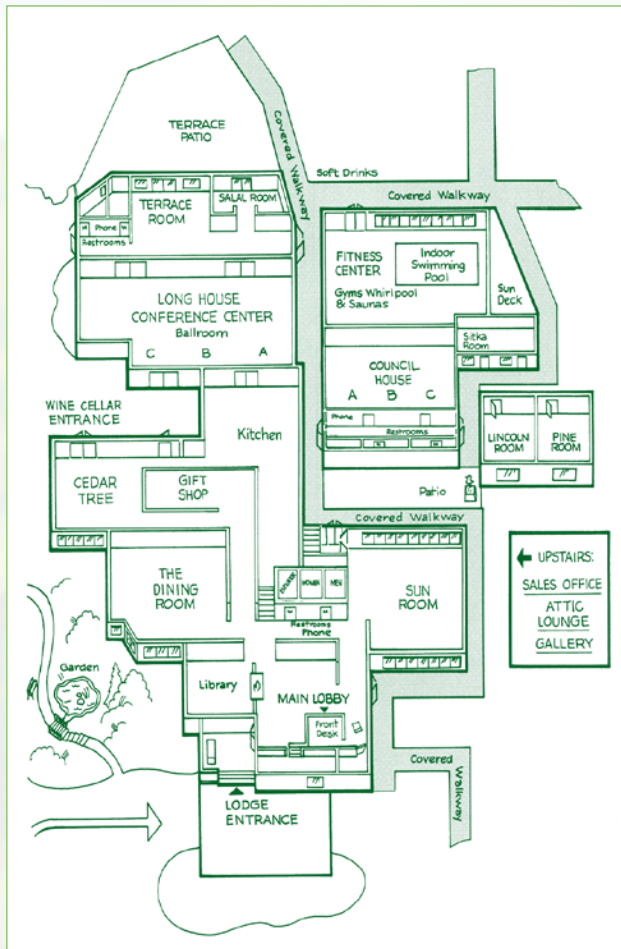

PREREGISTRATION DEADLINE IS DECEMBER 31, 2014

Preregistration is an easy way to register for the Annual Meeting. It facilitates meal projections, minimizes time required at the registration desk and saves you money over registering at the door. Preregistration packets may be picked up at the League's registration desk the day of the meeting.

Mail preregistration form with check payable to:

O.E.O.G.L. - Post Office Box 3366
Salem, Oregon 97302 • (503) 364-2944



OREGON ESSENTIAL OIL GROWERS LEAGUE

P. O. Box 3366, Salem, Oregon 97302
(503) 364-2944 • FAX (503) 581-6819

Visit oregonmint.org for more information.